



floor
distributors

URBAN
LAMINATE
COLLECTION
by FLOOR DISTRIBUTORS



PLEASE READ COMPLETELY BEFORE STARTING INSTALLATION

Please note that all installed floorboards will be deemed of an acceptable quality by installer and/or homeowner. Should you believe there are any defects with the product, please contact your retailer or wholesaler prior to installation of the flooring.

General Precautions

Flooring should be installed when conditions are between 15 – 30°C with a relative humidity of 30 – 70%. It is important that you install your flooring once the cartons are opened, not waiting several hours or days to do so. Do not store cartons directly on concrete or near outside walls.

The subfloor must be hard and level. Carpet etc must be removed before installation, but there is no need to remove an existing damp proof flooring, for example PVC flooring.

It is always recommended to use our recommended "*Performance Plus Underlay*" with the installation of **Urban Laminate** flooring. This underlay comes with an integrated damp proof barrier for extra subfloor moisture protection.

If you intend to install this flooring over underfloor heating or cooling, please contact your retailer for more specific information.

A new concrete floor must be dry at least 1 week per cm in thickness. With slabs over 4 cm in thickness you should double the drying time. That is a 4cm slab should be dry for 8 weeks.

Installation:

Make sure the subfloor is flat, clean dry and firm. Any variation in height greater than 2mm over a running 1 meter needs to be levelled.

To install **Urban Laminate** flooring you will need the following accessories. Spacers, Tapping Block, Underlay, Saw, Pencil, Safety Goggles and Gloves.

Please check floor panels prior to installation, panels with faults or defects should never be installed.

Make sure you mix floor panels prior to installation, this will help insure a random variation of colour throughout your installation.

It is important to properly measure the floor before installation. This will ensure that plank placement throughout the floor is visually acceptable, you should also ensure that the last row of flooring installed is at least 5cm wide.

Check that doors can open and close with adequate clearance, allowing for the thickness of flooring and underlay.

Urban Laminate flooring is not suitable for known wet areas, this includes installations in bathrooms.

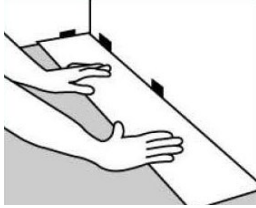

Install the first plank with spacers packed between the plank and the wall. Ensure the expansion gap is 10-15mm.

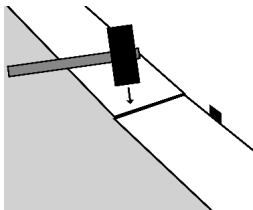

Use a soft rubber hammer to ensure the drop lock profile is properly engaged prior to installing the next plank.

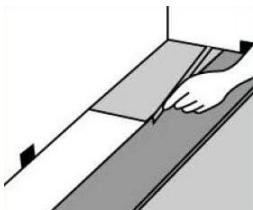

Continue this process until the wall is reached.

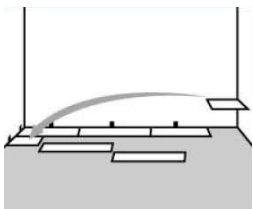

The offcut from the first row can be used as the first piece of flooring for the next row. Please ensure the 10 - 15mm gap is maintained throughout the installation and ensure that the stager between rows is at least 15cm.

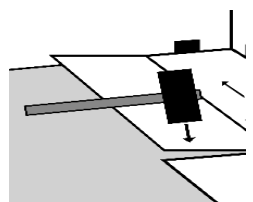

Click the second and remaining rows together rotating the boards horizontally at an angle of 20–30 Degrees. Gently tap the end joints into place using your rubber mallet. Ensure joints are staggered by at least 15cm.

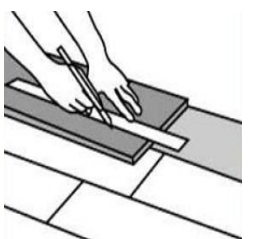

Make sure that the width of the last row is at least 5cm, and ensure that the gap around the perimeter of the floor remains at 10 – 15mm.

In rooms where the flooring length exceeds 12m, and width exceeds 8m, the use of an expansion joint is required. Always remember to use expansion joints (e.g. at doorways) throughout the flooring installation, particularly between rooms.

Fill expansion gaps with use of a suitable profile or skirting. Never glue profiles to the flooring itself, you must maintain free expansion around the perimeter of **Urban Laminate** flooring.

Once you've completed your **Urban Laminate** flooring installation it is immediately ready to walk on.

General Maintenance:

A dry maintenance regime is generally recommended for your **Urban Laminate** flooring. This includes the use of vacuum cleaners and sweeping. Use of dirt trapping mats at doorways are also recommended in reducing any abrasive wear, associated with foot traffic.

We never recommend the use of steam cleaners on Urban Laminate flooring.

Wet maintenance is not acceptable on **Urban Laminate** flooring. When cleaning your floor always ensure that moisture is removed immediately by using a dry cloth.

Always protect your floor by use of floor protectors under tables and chairs.